



Sense
Measure
Control

Model ASMPB Airbox Pressure Transducer

- *Miniature Size*
- *1 Bar to 5 Bar Absolute Range*
- *Aluminium Construction*
- *Amplified Output*
- *5V or 8-16V Supply*
- *Lightweight*



The ASMPB Series of cost effective high performance pressure transducers have been designed for air box or boost pressures in demanding motorsport and automotive applications.

These are ideal for high precision data acquisition or control systems. The transducers can be installed directly onto vehicles or as part of a test stand or dyno.

The transducers offer a high level of reliability and endurance, they are protected against the high vibration, shock and high temperatures found in motorsport.

The modular construction and programmable amplifier provide a fast delivery time for standard and custom configurations.

Pressure ranges are available between 1 bar to 5 bar absolute reference.

Industry standard 3-wire electrical connections allow configuration with most common ECU's and data logging systems.

The ASMPB Series are race proven and can be found in many race formula around the world.

For OEM applications we have many options available to customise these transducers at a sensible cost.

Typical applications include: Air Intake - Boost – Barometric

KA Sensors is a dynamic company with over 30 years of sensor and instrumentation experience in the motorsport industry. We offer a strong engineering led service to all of our customers, with speed of response and confidentiality being paramount.

Please contact us for further expert assistance with your application.

KA Sensors Ltd – The Old Malthouse – Springfield Road – Grantham – NG31 7BG – UK

Tel: +44 (0)1476 568057

Fax: +44 (0)1476 561495

Email: sales@kasensors.co.uk

Web: www.kasensors.com

ASMPB.1012

Specifications

- **Range: Bar**
Standard ranges: 1, 2, 4, 5
Absolute
- **Safe Over Range**
150% of range
- **Burst Pressure**
>300% of range
- **Accuracy**
±0.5% FS combined linearity & hysteresis
- **Thermal Effects**
Zero: ±0.04% FS/°C
Sensitivity: ±0.04% of reading / °C
- **Output**
0.5V to 4.5V (others available)
- **Supply**
5V (±0.5V) ratiometric or 8-16Vdc
- **Operating Temperature Range**
-20°C to +135°C
- **Compensated Temperature Range**
0°C to +125°C
- **Construction**
Black anodised aluminium, Alumina, Viton, FEP
- **Electrical Connection**
Metri-pack (Packard) 150 series connector
- **Thread size**
Barb to suit 4mm ID Tube
- **Protection Class**
IP67
- **EMC Protection**
EN 50082-1
- **Vibration**
Mil-Std-810C, Curve L, 20G
- **Weight**
34g (Inc Cable)
- **Options**
Cable Assembly
Part Number Labelling

How to Order

- **Please provide information as below:**
Model: ASMPB
Range: Bar
Supply Voltage
Thread Size
Connector Fitted
Part Number Label

Standard Configuration

Dimensions in mm

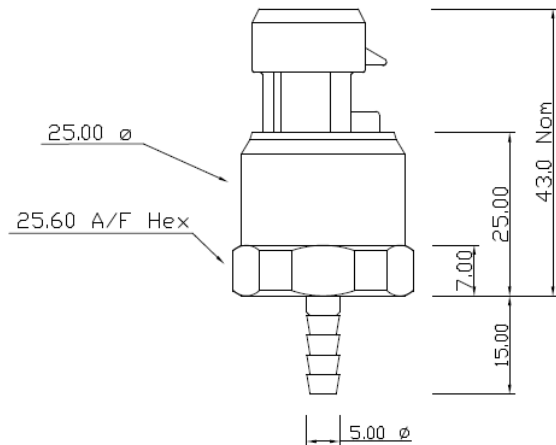

Other Products

- **KA Sensors offer a wide range of products and services to the Motorsport Industry.**
- **Sensors:** Pressure, Force, Torque, Temperature, Acceleration, Displacement, Angle, Speed
- **Other capabilities:** Telemetry, data logging, Electronics design, Controls, Wiring.
Please contact us for additional information.

KA adopts a continuous development program which sometimes necessitates specification changes without notice

KA Sensors Ltd – The Old Malthouse – Springfield Road – Grantham – NG31 7BG – UK

Tel: +44 (0)1476 568057

Fax: +44 (0)1476 561495

Email: sales@kasensors.co.uk

Web: www.kasensors.com

ASMPB.1012